

Installation Manual

Installing the Comtec LightSpeed B ONT Cabinet into Etisalat's FTTH Network

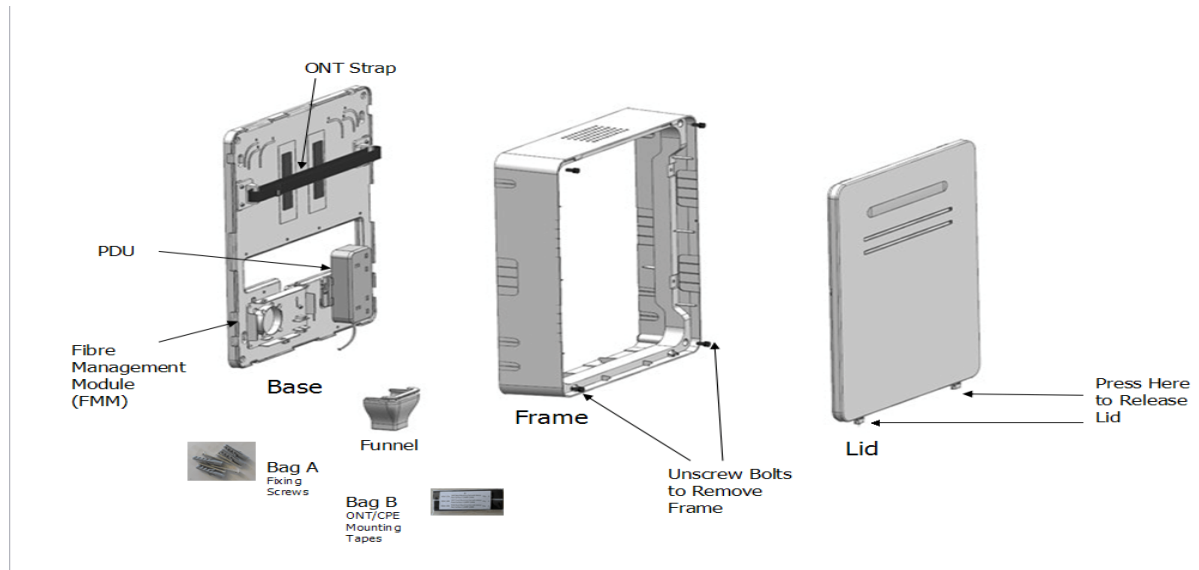

For the installation of the cabinet you will require the following tools:

- Electric drill with drill bit to suit a rawl plug that accepts a 4 x 80mm screw
- Cross-headed screw-driver to suit the above screw
- Hex-headed screw-driver
- Side cutters and/or junior hacksaw

1. Remove the lid from the frame by pressing the 2 buttons on the bottom edge of the lid and levering it up and then down.
2. Remove the frame from the base by unscrewing the 4 hex-headed bolts located in the corners of the frame (these bolts are held captive within the frame so do not try to remove them completely).
3. Hold the base to the wall and mark the 4 mounting screw locations through the slots in each corner of the base. Remove the frame from the wall and drill holes to suit an 8 x 40mm rawl plug. Insert the rawl plugs (rawl plugs and screws are supplied with the ONT Cabinet in Bag A) then hold the frame against the wall and fix it to the wall with the 4 screws.
4. Terminate the fibre drop cable with an SC/APC FAST connector (or similar) and insert the connector into an SC/APC adaptor (the connector and adaptor are not supplied with the ONT Cabinet).
5. Run the fibre drop cable into the Fibre Management Module (FMM) at the top left corner of the FMM, run a few loops of the cable counter-clockwise around the fibre management spool and clip the SC/APC adaptor into the holder at the bottom right of the FMM. Plug one end of an SC/APC patchcord (not supplied with the ONT Cabinet) into the other side of the SC/APC adaptor.
6. Fix 2 strips of self-adhesive mounting tape (supplied with the ONT Cabinet in Bag B) to the ONT– use the soft-sided mounting tape that grips to the rough-sided mounting tape

that is already installed on the base – in a horizontal orientation (if possible avoid covering any ventilation slots of the ONT).

7. With the ONT strap passed over the ONT position the ONT on the base referring to the alignment guides marked near to the top of the base as follows:
 - Alignment guide A: Huawei HG851A ONT
 - Alignment guide B: Zhong Hone GPON 2424 ONT
 - Alignment guide C: Huawei HG8240 ONT
8. Plug the other end of the SC/APC patchcord into the optical port of the ONT but avoid putting any tight bends on the patchcord. If no other CPE device is to be installed tighten the ONT strap over the ONT.
9. If a second CPE device, such as an RGW, is to be installed then mount this to the already-installed ONT by applying 2 strips of self-adhesive rough-sided mounting tape to the top surface of the ONT and 2 strips of self-adhesive soft-sided mounting tape to the underside surface of the second CPE device. The tapes on the ONT should run perpendicular to the tapes on the second CPE device. Ensure that the ONT strap runs over the top of the second CPE device and tighten the ONT strap over it.
10. Plug the outgoing RJ45 and/or RJ11 cables into the ONT and/or second CPE device (as appropriate).
11. Insert the power-plugs of the ONT and/or the second CPE device into the PDU. The ONT cabinet has been designed to accept most modern power-plugs but if the power-plug is too large it will need to be located outside the cabinet and the low voltage cable routed into the cabinet. Plug the low voltage cable(s) from the power-plug(s) into the ONT and/or second CPE device as appropriate, insert the plug of the PDU's trailing lead into a mains power socket and power-on these devices. Ensure the indicator lights on the device(s) are lit.
12. The bottom side of the frame has 3 knock-out cable entry ports; 1 small one on the left and a large one in both the centre and on the right. The larger port accepts the funnel supplied with the ONT Cabinet. Cut out these ports as required using a small saw/pliers and fit the funnel into one of the larger ports as appropriate.
13. Fasten the frame back to the base with the 4 hex-headed bolts located in the corners of the frame and feed the cables through the relevant ports.
14. Slide the lid onto the flanges at the upper edge of the frame then lower the bottom edge of the lid onto the lower part of the frame until it clicks securely into position.
15. Run trunking for the fibre optic drop cable, mains power cable, Cat 6 cable etc between the cabinet and the appropriate locations in the building (mains power socket, Cat 6 sockets etc) and insert the cables into this. Note that, to aid installation, the funnel does not require an accurately cut length of trunking because it accepts 5 to 25mm of trunking inserted into it.

For Further Information Please Visit www.comtecdirect.co.uk